

## Quick Installation Guide

Wireless N ADSL2+ Modem Router

Suitable for: ND150,ND300

Ver.DS1405

Copyrights 2014 by TOTOLINK All rights reserved. Website: <http://www.totolink.net>  
Information in this document is subject to change without prior notice.

# 1 Hardware Installation

The RJ11 port of this Modem Router can only connect to ADSL Filter. Please follow steps in below diagram in correct order.

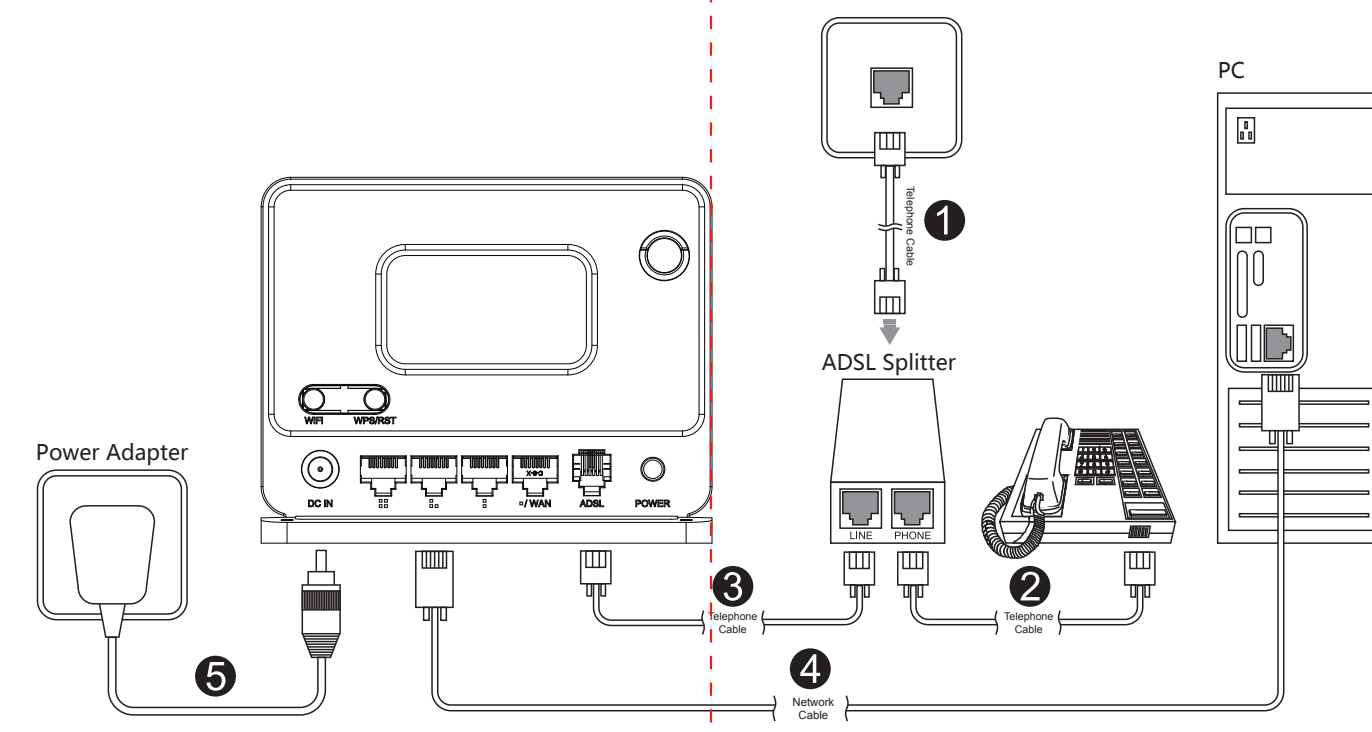

### Ports and Buttons Description

<b>DC IN</b>	This socket is used to connect the power adapter.
<b>POWER</b>	This button is used to power on or off the ADSL Router.
<b>ADSL</b>	This RJ11 ADSL port is used to connect to the ISP.
<b>1 LAN/WAN</b>	This port is used to connect the router to the local PC/Internet.
<b>2/3/4 LAN</b>	These ports are used to connect the router to local PC.
<b>WPS/RST</b>	Press the button for more than 5 seconds, the router will restore factory settings. For less than 5 seconds, the router will establish Wi-Fi protected settings(WPS) automatically.
<b>WIFI</b>	This button is used to power on/off the WIFI signal.

### NOTE:

1. Please disconnect the power adapter and all cables during thunderstorm weather.
2. Keep away from heat source and keep well ventilated.
3. Please pay attention to the waterproofing and moisture-proof when storing, transporting and running.
4. The power supply must reach the rated current and power.
5. Put the router in flat places.

# 2 Set Up PC

**Windows 2000/XP** For Windows 2000 or Windows XP Operating System, please comply with following steps to set up.

1. Right-click "My Network Places", click "Properties"
2. Right-click "Local Area Connection", click "Properties"
3. Double-click "Internet Protocol (TCP/IP)"
4. Choose "Obtain an IP address automatically" and "Obtain DNS server address automatically", click "OK"; go back to previous interface and click "OK"

**Windows Vista/7** For Windows Vista or Windows 7 Operating System, please comply with following steps to set up.

1. Click "Start—Control Panel—Network and Internet—Network Connection", right-click "Local Area Connection", and choose "Properties".
2. Double-click "Internet Protocol Version 4 (TCP/IPV4)"
3. Choose "Obtain an IP address automatically" and "Obtain DNS server address automatically", click "OK"; go back to previous interface and click "OK"

# 3 Set Up Router

Please set up the router following below steps.

1. Run the Web browser.
2. Type <http://192.168.0.1> in the web browser, then press Enter.
3. Input the Username and Password, then click Login button (The default Username and Password is admin).
6. Setup the wireless parameters, then click APPLY to save your settings.
7. Now, you have finished Easy Setup, click CLOSE.

**NOTE:** After you set the Pre-Shared Key, please remember your SSID and the Pre-Shared Key to connect with your wireless LAN.

4. Choose Easy Setup. Select the language according to your country and click NEXT. (The default language is English).
5. Fill in the related content based on the information provided by your ISP, click Next.

# 4 Wireless Network Connection

1. Right-click "My Network Places", click "Properties"
2. Right-click "Wireless Network Connection", and click "View Available Wireless Networks"
3. Confirm the wireless network SSID name, choose one that you would like to connect, then click "Connect"
4. Input the encryption key and click "Connect"
5. Have connected wireless network, you can access Internet through wireless mode.

# 5 FAQ

1. How to reset the router to default factory settings?  
1. When the router is powered on, press the WPS/RST button for about 10s.  
2. The router's CPU LED indicator keeps flashing, which means you have reset your router to default settings successfully.
2. How to find the IP address and user name & password on the device?  
On the rear panel of the Router, there is IP address, User name and password printed on the sticker. See below:

