



## Parabolic antenna JRMB - 900 -10 UPB

Antenna JRMB – 900 – 10 UPB is designed for microwave links at the frequency bands 10 GHz. It has deep reflector dish and massive bracket JDMW-900 which allows precise adjustment in both directions. Whole antenna system has extreme wind stability.

### Electrical parameters:

<b>Frequency range</b>	10.1 – 10.7 GHz
<b>Gain</b>	37.2 dBi
<b>Side lobe level</b>	≤ 15 dB
<b>Front to back ratio</b>	≥ 47 dB
<b>Beamwidth<sub>-3 dB</sub></b>	2.3°
<b>Polarization</b>	According to mounting unit - 2 x 45° or Vertical / Horizontal
<b>Return loss (VSWR)</b>	≥ 18 dB ( ≤ 1,3)

### Mechanical parameters:

<b>Parabola</b>	Aluminium alloy
Size	Ø 900 mm
Depth	331 mm
<b>Cover</b>	UV steady plastic ABS
<b>Input / output</b>	Circle waveguide 19.5 mm Compatible with PowerBridge M10
<b>Installation for mast</b>	Ø 40 - 120 mm
<b>Operating wind load</b>	140 km/h
<b>Survival wind load</b>	210 km/h
<b>Weight of antenna</b>	11.9 kg (26.23 lbs.)
<b>of bracket</b>	4.3 kg (9.48 lbs.)
<b>Shipping dimensions</b>	1000 mm x 1000 mm x 490 mm

The antenna is supplied together with a bracket that allows easy mounting on a mast. Bracket can be installed separately on the mast. Subsequently, you can simply hang up the antenna with microwave unit into it. We recommend mounting on the mast with minimal Ø 70 mm in the areas with the occurrence of the adverse weather conditions. Bracket allows fine setting elevation (of gradient) and azimuth ± 20°. It is possible to mount to right and left side.

## Parabolic antenna JRMB - 900 - 10 UPB

### Measurement of radiation pattern:

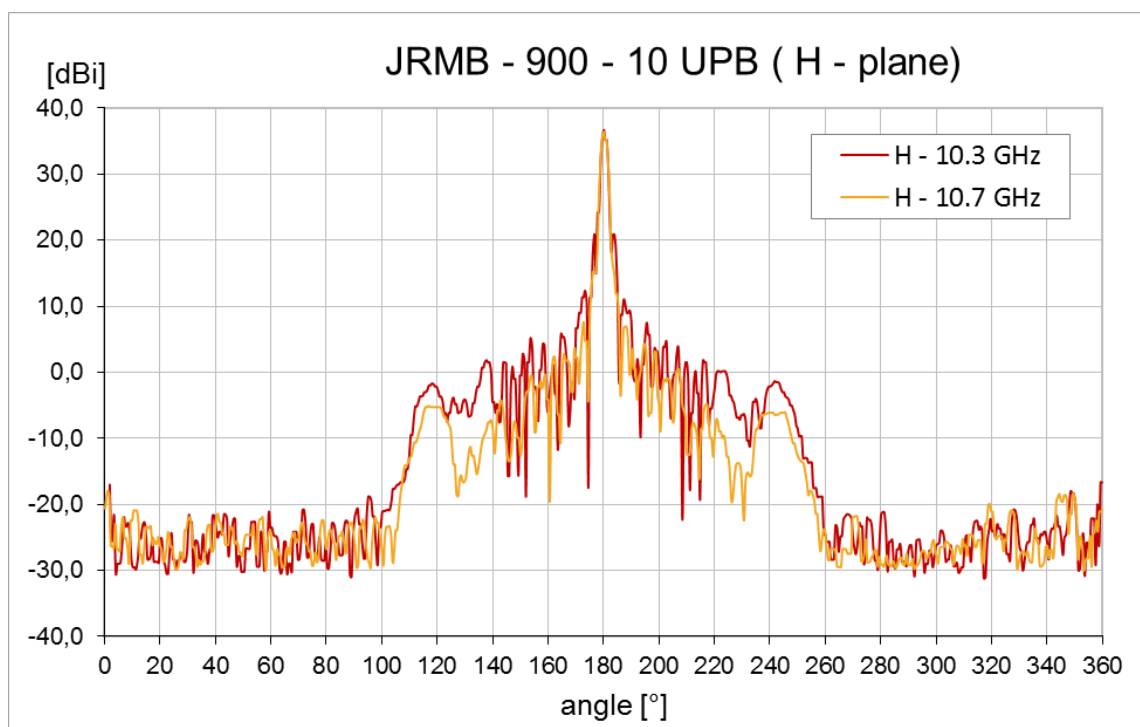
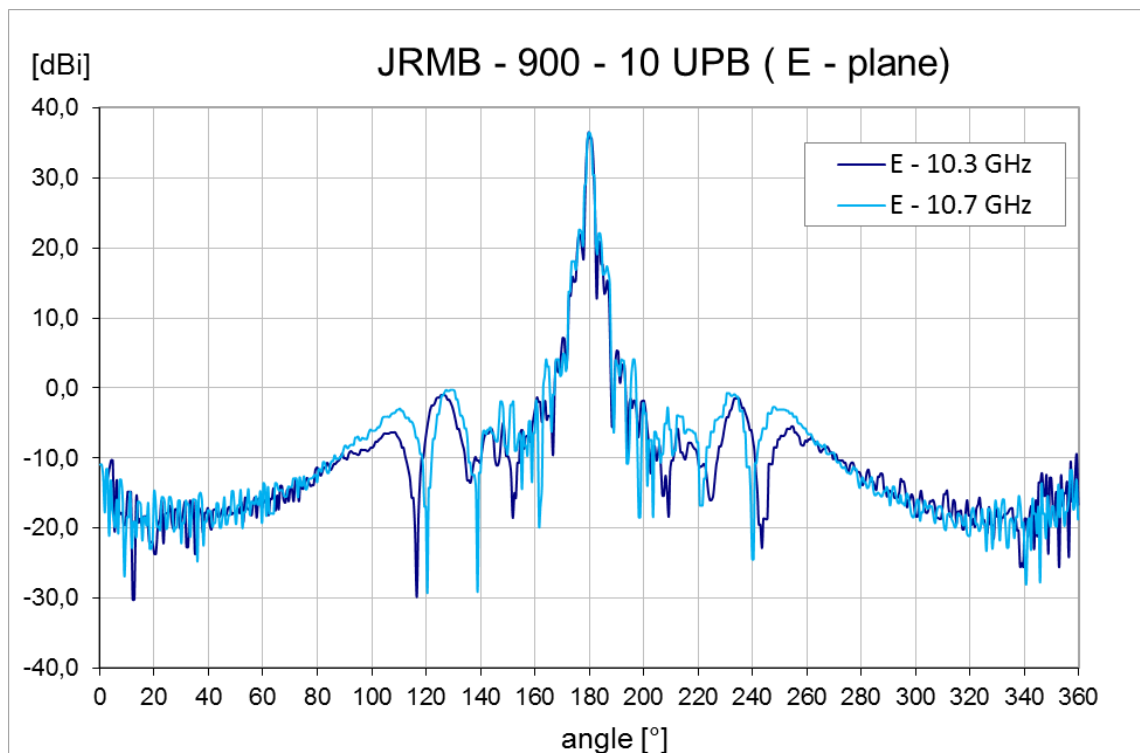

## Parabolic antenna JRMB - 900 -10 UPB

### Outline:

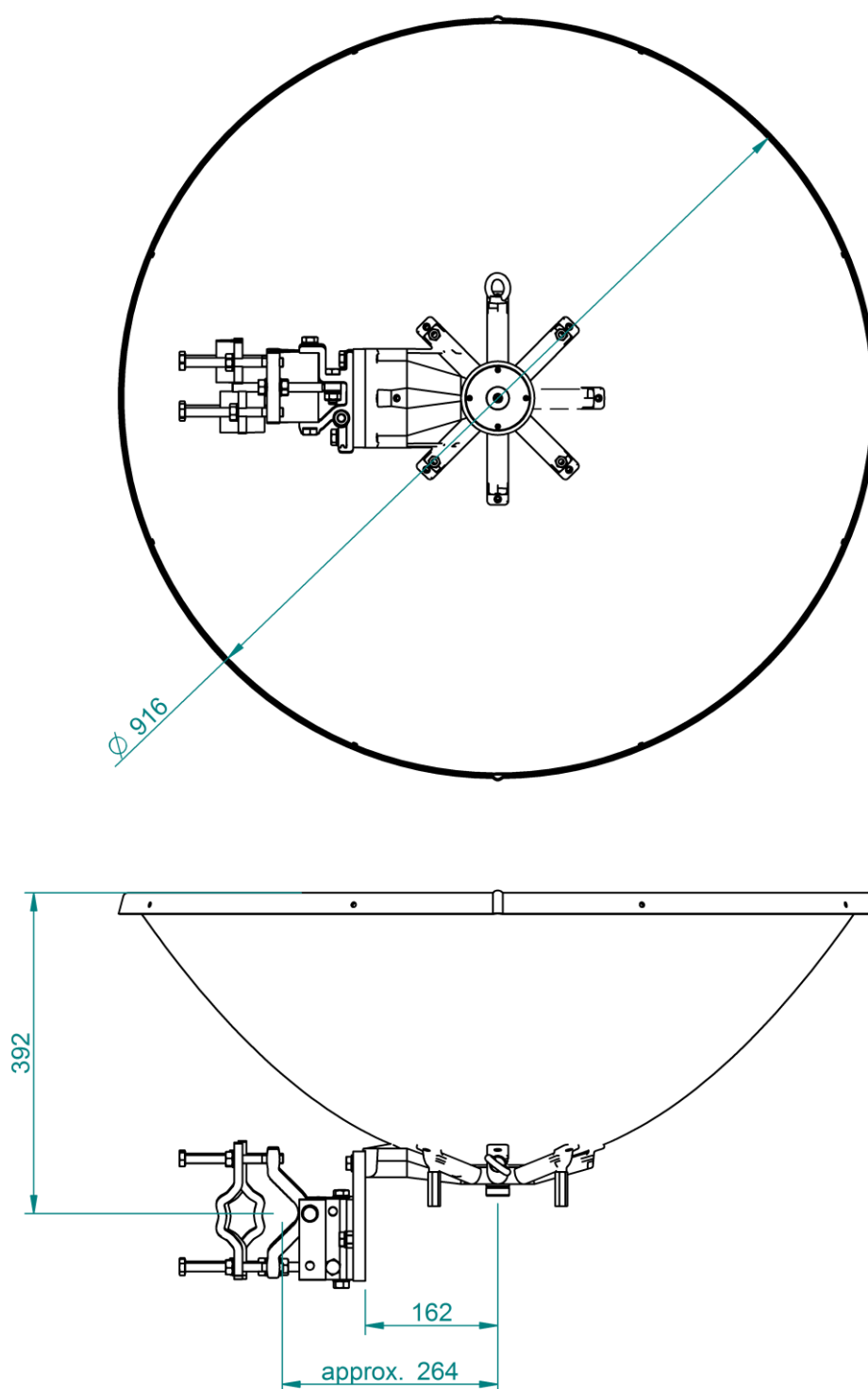

## Parabolic antenna JRMB - 900 -10 UPB

### Wind loading:

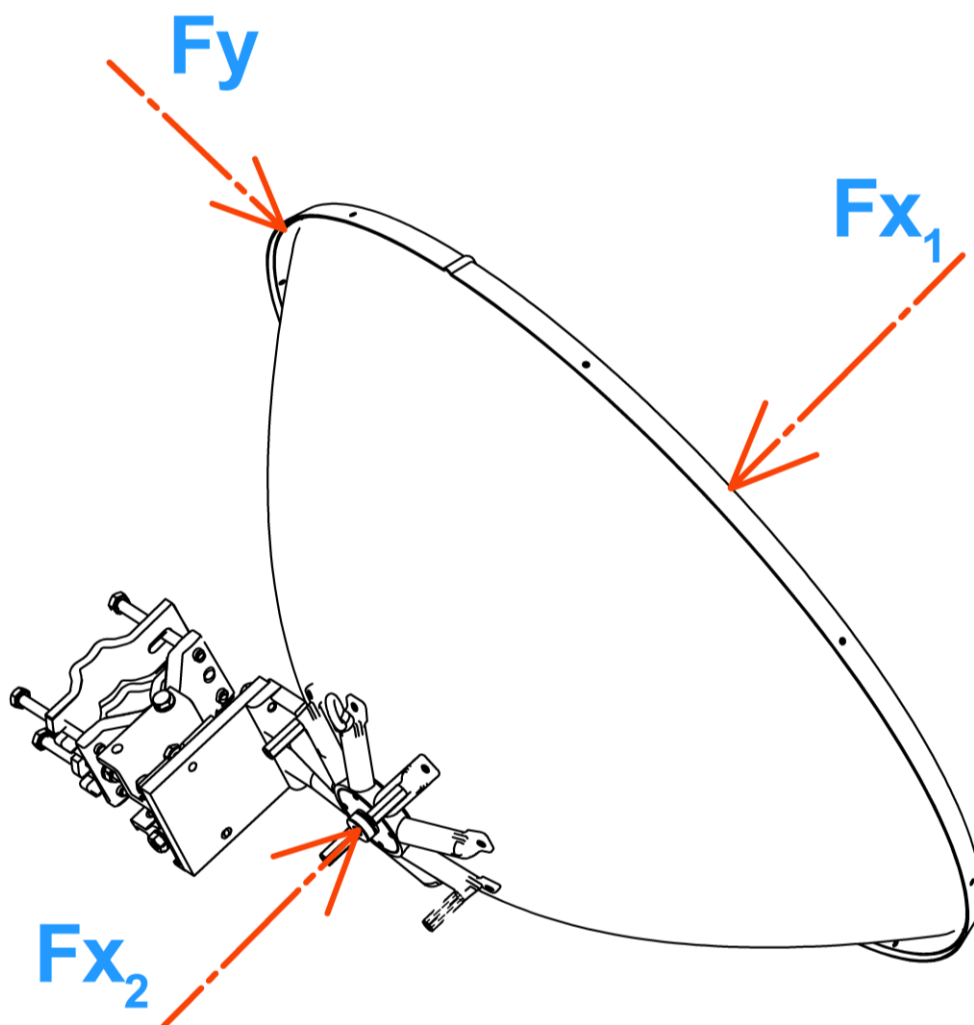

Wind Loading at 200 km/h (125 mph)		
Direction	Force [N]	Force [lbf]
Fx1	1443	325
Fx2	1324	298
Fy	91	20,5